

# SWISSMA DOPPELWELT® STANDING SEAM ROOF SYSTEM

**LEGEND:**

- ① 0.48mm BST (0.53mm TCT) SWISSMA DOPPELWELT® STANDING SEAM ROOF IN COLORBOND® STEEL
- ② STAINLESS STEEL CLIPS
- ③ 5mm THICK SWISSMA SM-NDI FOAM
- ④ 1mm THICK ZED SPACER IN ZINCALUME® STEEL @ 600mm C/C
- ⑤ 50mm x 175kg/m<sup>3</sup> HARDROCK
- ⑥ 0.42mm BST (0.47mm TCT) SWISSMA SANKO SPEED DECK® UNDERLINER IN ZINCALUME STEEL®
- ⑦ PURLIN @ 1200mm C/C BY OTHERS

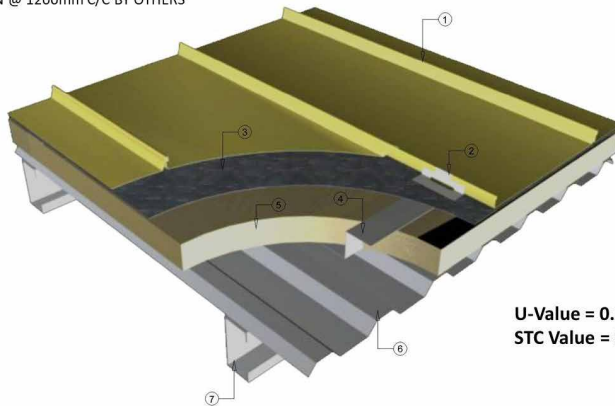

U-Value = 0.56 W/m<sup>2</sup>K  
STC Value = 37

\*NB: Can be customised to meet U-Value = 0.40 W/m<sup>2</sup>K

**WHY IS IT GREEN?**

- Customised energy efficient roof system (light weight group) – Reduces energy costs compared to conventional roofing material.
- Incorporated with acoustic treatment solution – Better internal noise control.
- A component of CIDB (QLASSIC) / IBS System – Easy and quick to install.
- Using high solar reflectance index (SRI) roofing sheet incorporated with IR pigments technology and low thermal mass property – Reduces UHI intensity.
- Material can be reused and recycled during and after construction.
- Consists of recycled content material – Reduced GHG impact.
- Lightweight roof system – Reduced structural material cost and usage.
- Roof system can be fitted out to provide integrated solar system and rainwater harvesting solution – Encourages renewable energy / rainwater harvesting.

**PRODUCT FEATURES**

- Provides a custom-made solution to achieve specific design requirements.
- Achieves good acoustic values (e.g. STC 37, STC 45, STC 50, STC 60).
- Low roof U-values (e.g. 0.4W/m<sup>2</sup>K or lower) to meet MS 1525 and MS 2680 Standards.
- Adaptable or flexible to all roof shapes with tapered and curved features i.e. sleek, elegant and stylish design.
- Concealed sliding fixing system to allow for thermal expansion/contraction.
- Completely leak-proof roof system.
- Complemented by a full range of custom-made accessories, which comply with International Standards to satisfy the most intricate of details.
- Up to 30 years material warranty with COLORBOND® steel series range of products.
- Highly resistant to tropical weather and ensures matte finish of the roof.
- Developed and manufactured in Malaysia for tropical climates.

**APPLICABLE GBI CREDITS**

<b>NRNC</b>	EE1, SM12, MR2, MR3, EQ13
<b>RNC</b>	EE1, EE2, SM13, MR2, MR3, EQ13
<b>INC</b>	EE1, SM14, MR2, MR3, EQ13
<b>NREB</b>	EE1, SM6, MR2, MR3, EQ13
<b>IEB</b>	EE1, SM6, MR2, MR3, EQ13

**COMPANY DETAILS**
**SWISSMA BUILDING TECHNOLOGIES SDN BHD**

Jalan Utas (15/7),  
Shah Alam Industrial Estate,  
P.O. Box 7053, 40700 Shah Alam,  
Selangor Darul Ehsan, Malaysia

**TEL** +603 5519 1360

**FAX** +603 5510 1362

**EMAIL** enquiry@swissma.com

lowph@swissma.com

alex pang@swissma.com

**WEB** www.swissma.com

The contents of this Product Data Sheet has been compiled from information supplied by the company and/or their agents and are not necessarily endorsed by GreenPagesMalaysia. Whilst every effort has been made to ensure accuracy in the preparation of this Product Data Sheet, the Publisher, its staff, agents and printers accept no responsibility for any errors or omissions that may occur. © GreenPagesMalaysia.