

SWISSMA SANKO ROOF SYSTEM

LEGEND:

- ① 0.42mm BST (0.47mm TCT) SWISSMA SANKO GRIP DECK® 3-PAN ROOF IN COLORBOND® STEEL
- ② CONCEALED BRACKET
- ③ SINGLE SIDED ALUMINIUM FOIL (V-FOIL ENVIRO-TUFF WF301)
- ④ 1mm THICK ZED SPACER IN ZINCALUME® STEEL @ 1200mm C/C
- ⑤ 100mm x 24kg/m³ ECOWOOL (compressed to 85mm height) or 100mm x 40kg/m³ COOL 'N' COMFORT ROCKWOOL (compressed to 85mm height)
- ⑥ 0.42mm BST (0.47mm TCT) SWISSMA SANKO SPEED DECK® UNDERLINER IN ZINCALUME STEEL®
- ⑦ PURLIN @ 1200mm C/C BY OTHERS

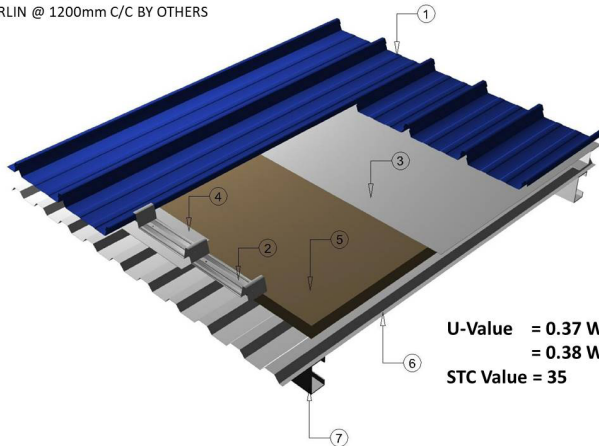

U-Value = 0.37 W/M²k (Ecowool)
= 0.38 W/M²k (Rockwool)
STC Value = 35

WHY IS IT GREEN?

- Customised energy efficient roof system (light weight group) – Reduces energy costs compared to conventional roofing material.
- Incorporated with acoustic treatment solution – Better internal noise control.
- A component of CIDB (QLASSIC) / IBS System – Easy and quick to install.
- Available in high solar reflectance index (SRI) roofing sheet incorporated with IR pigments technology and low thermal mass property – Reduces UHI intensity.
- Material can be reused and recycled during and after construction.
- Consists of recycled content material – Reduced GHG impact.
- Lightweight roof system – Reduced structural material cost and usage.
- Roof system can be fitted out to provide integrated solar system and rainwater harvesting solution – Encourages renewable energy / rainwater harvesting.

PRODUCT FEATURES

- Sanko products have more than 43 years track record in Malaysia.
- Provides a custom-made solution to achieve specific design requirements.
- Achieves good acoustic values (e.g. STC 37, STC 45, STC 50, STC 60).
- Low roof U-values (e.g 0.4W/m²K or lower) to meet MS 1525 and MS 2680 Standards.
- Suitable for long length and low-pitched roof installation.
- Sanko's deep corrugation profiles like Sanko Seam Lock®, Sanko Roof Deck®, Sanko Grip Deck® 3-Pan and Sanko S-60® can be produced at the site in one piece to avoid end lapping and leakage.
- Sanko S-60® profile can be installed at purlin spacing up to 10m C/C.
- Concealed fix and no roof puncture.
- Complemented by a full range of custom-made accessories, which comply with International Standards to satisfy the most intricate of details.
- Up to 30 years material warranty with COLORBOND® steel series range of products.

PRODUCT CERTIFICATION & COMPLIANCE

- FM Approvals Class: 4451

APPLICABLE GBI CREDITS

NRNC	EE1, SM12, MR2, MR3, EQ13
RNC	EE1, EE2, SM13, MR2, MR3, EQ13
INC	EE1, SM14, MR2, MR3, EQ13
NREB	EE1, SM6, MR2, MR3, EQ13
IEB	EE1, SM6, MR2, MR3, EQ13

COMPANY DETAILS

SWISSMA BUILDING TECHNOLOGIES SDN BHD

Jalan Utas (15/7),
Shah Alam Industrial Estate,
P.O. Box 7053, 40700 Shah Alam,
Selangor Darul Ehsan, Malaysia

TEL +603 5519 1360

FAX +603 5510 1362

EMAIL enquiry@swissma.com

lowph@swissma.com

alex pang@swissma.com

WEB www.swissma.com

The contents of this Product Data Sheet has been compiled from information supplied by the company and/or their agents and are not necessarily endorsed by GreenPagesMalaysia. Whilst every effort has been made to ensure accuracy in the preparation of this Product Data Sheet, the Publisher, its staff, agents and printers accept no responsibility for any errors or omissions that may occur. © GreenPagesMalaysia.